

HET BOUWEN VAN EEN EENGEZINSWONING

bouwheer:

N.V. SF Construct
Industrieterrein 1/25A
3290 Diest



STYLISH
FAMILY HOMES

perceel:

13-05-2025

STEENBEEKHOF 25 (Lot 1) - STERREBEEK 1933

Inhoud:

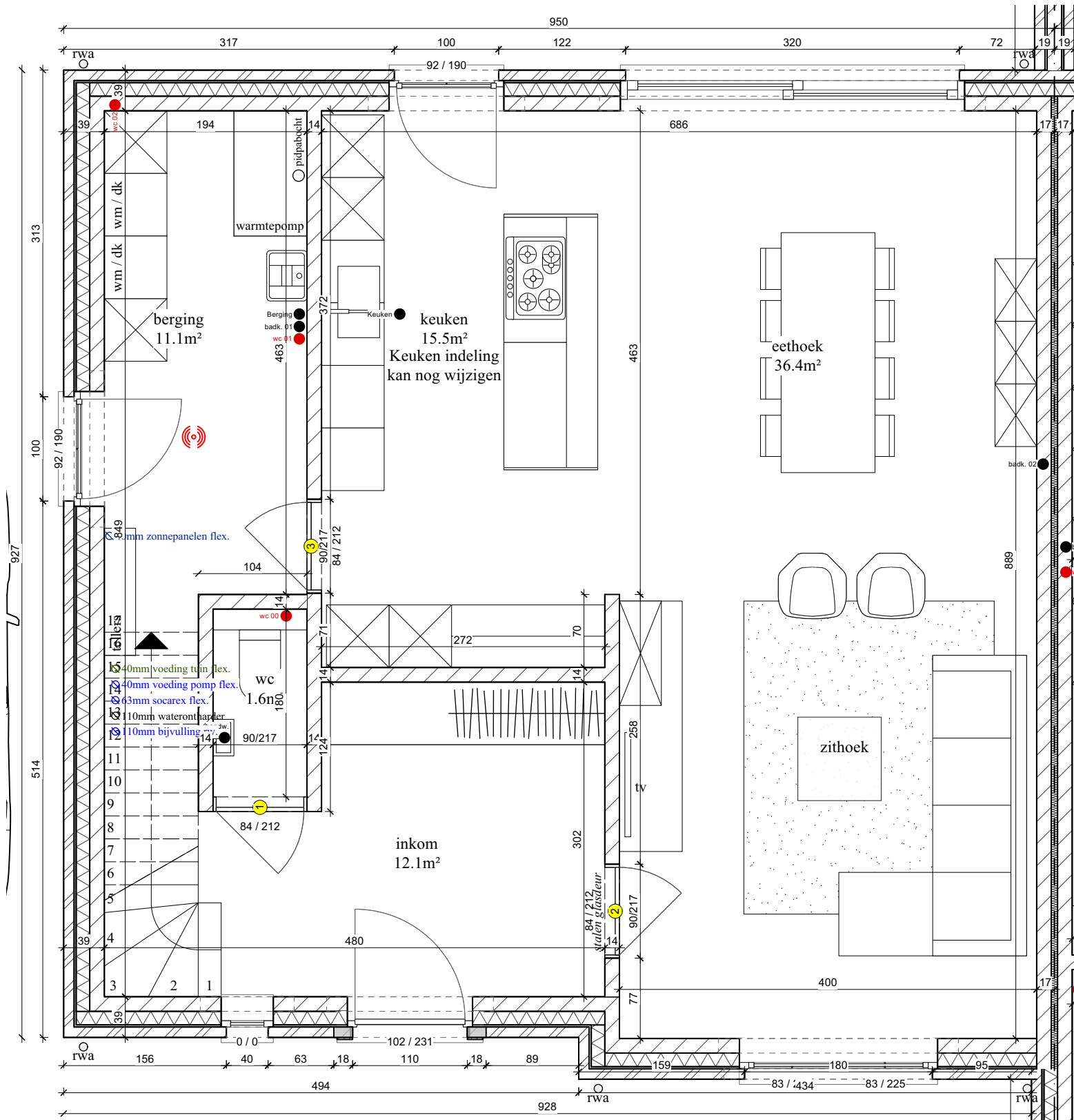

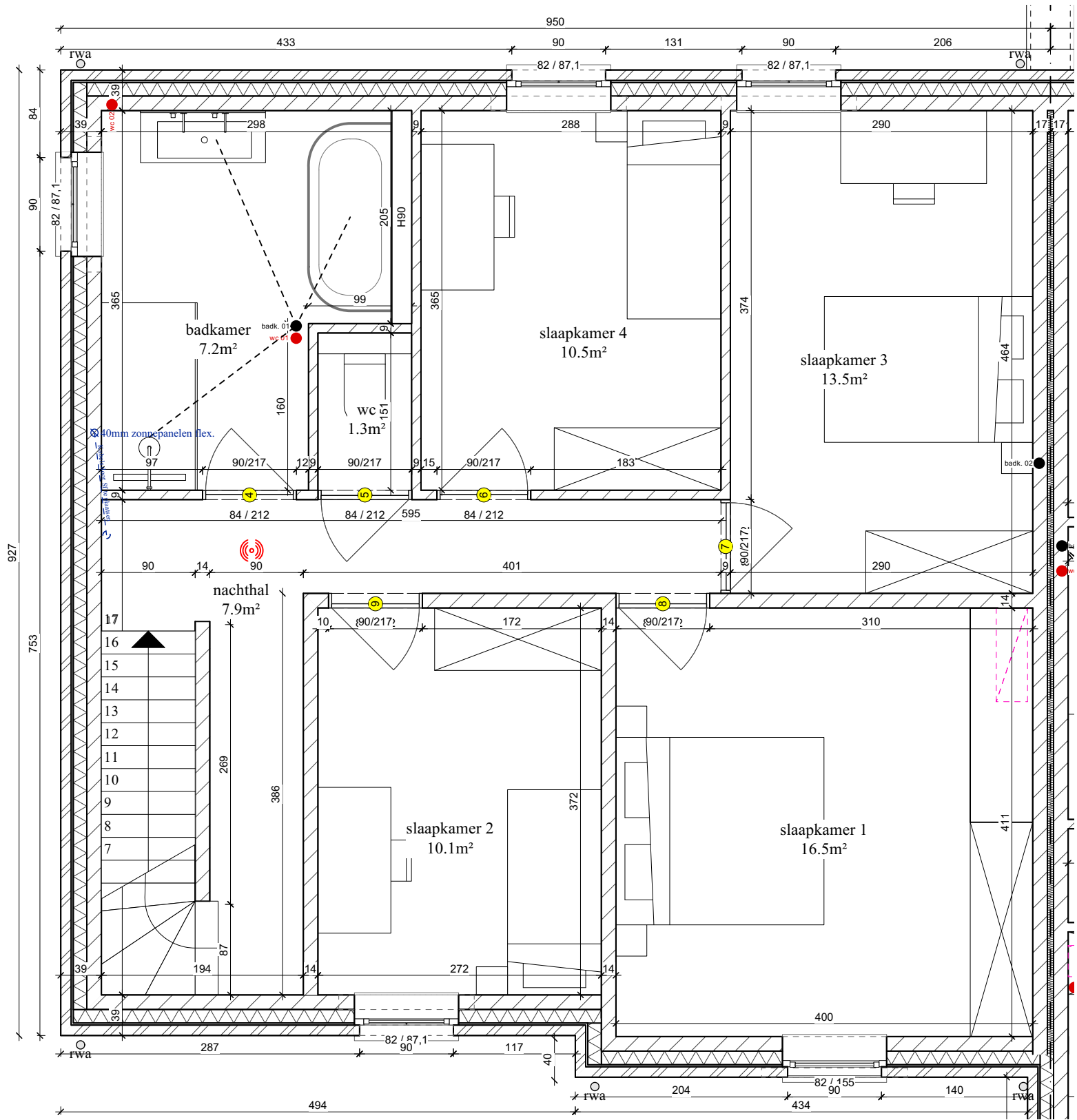

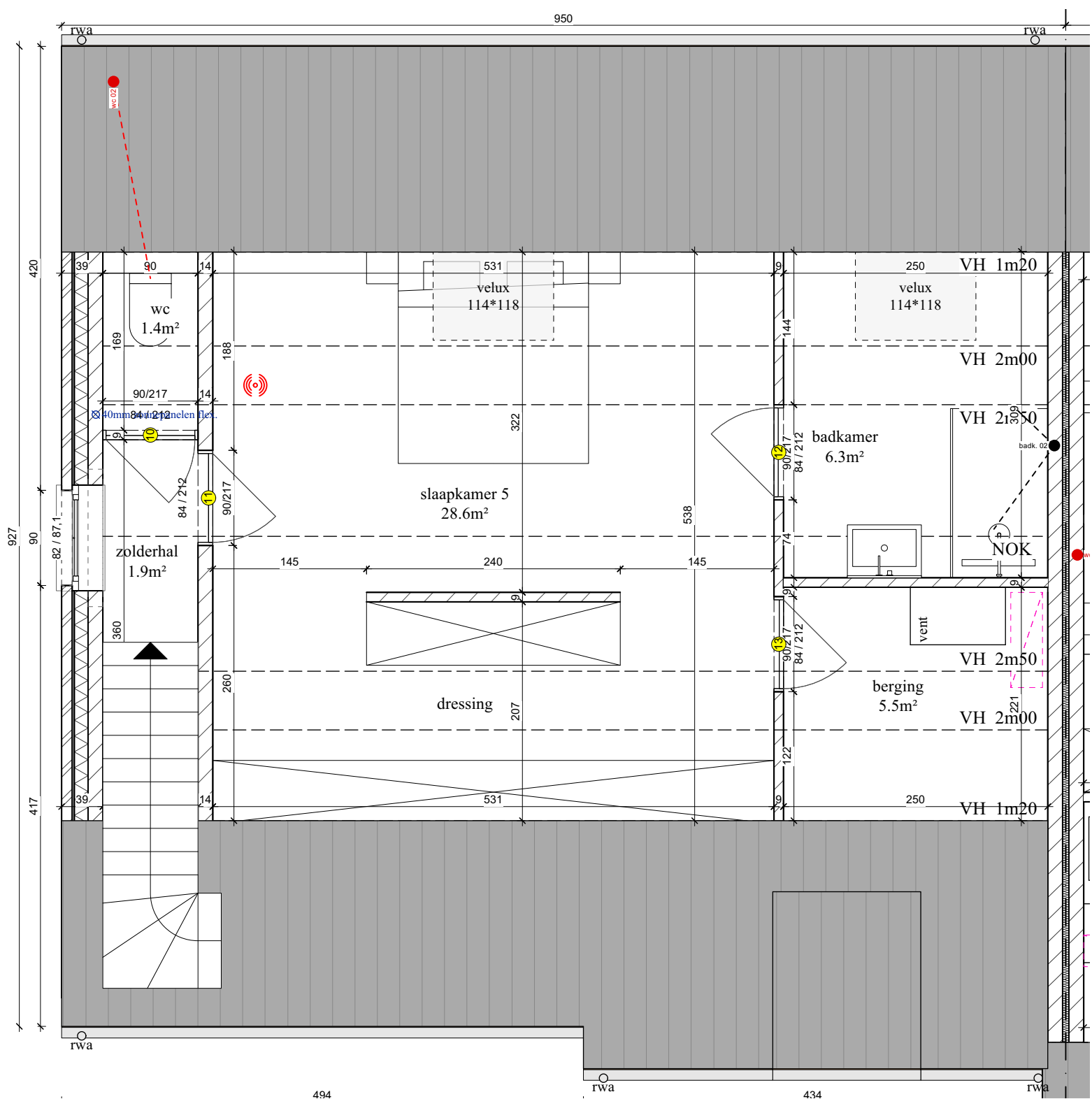



Woning 1



STYLISH
FAMILY HOMES

STEENBEEKHOF 25 (Lot 1) - STERREBEEK 1933

Vorgevel

datum 13-05-2025
schaal 1/50



Woning 1

Perceelsgrens

